

Catalogue



Contents

	Page
Blue Concrete Screws	8
Blue Purlin Screws	11
Bugle Batten Screws	10
Coach Screws Stainless	11
Decking Screws	9
Euro Screws	7
FastRight Quick Screws	9
Gib Screws	10
Gutter Bolts	13
H Packers	5
Hex Bolts Stainless	11
HingeFix - Wood Screws	7
Hollow Wall Anchors	13
Landscaping Screws	15
Machine Screws	12 - 13
MultiFix - Wood Screws	7
Nuts	14
Rawlplug - Concrete Bolts, Light Duty Fixings, Chemset	17 - 19
Rivets/Rivet Tools	20 - 22
Self Tapping Screws	16
SureFix - Wood Screws	6 - 7
Tek Screws Metal	9
Tek Screws Wood	8
Threaded Rod	10
Tiewire Screws	16
Timber Connection Hardware	3 - 4
Wing Tek	9
Washers	13

Timber Connection Hardware



PK CODE	SIZE	FINISH	PACK QTY	UNIT
concealed purlin cleats				
HGPCPC40	40mm	galv	100	each
HGPCPC80	80mm	galv	100	each
HGPCPC40SS	40mm	stainless	100	each
HGPCPC80SS	80mm	stainless	100	each

pile bearer kit				
PBKIT6S	c/w left & right brackets, U nails, 30mm & 100mm nails		6kn	304 stainless each
PBKIT12S	c/w left & right brackets, nail on plates, 30mm & 100mm nails		12kn	304 stainless each

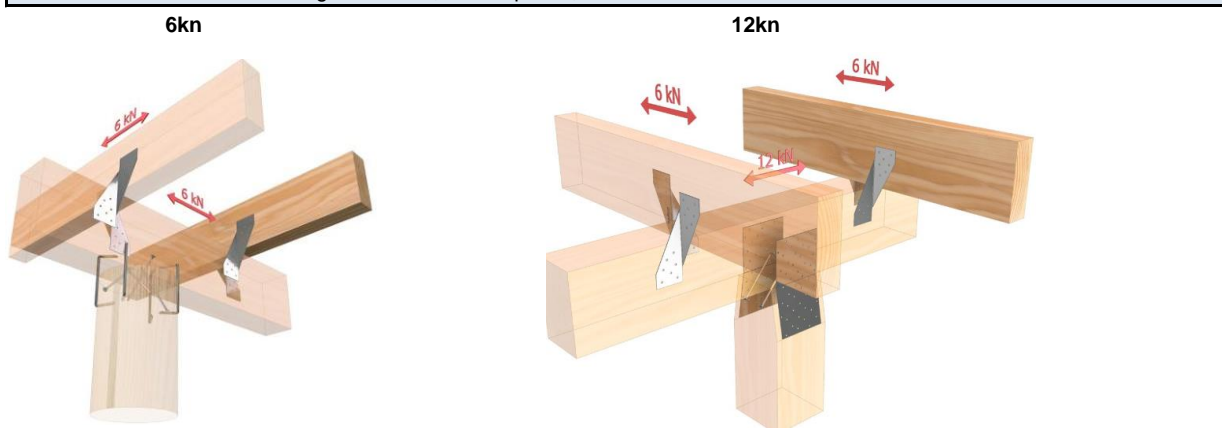

pile bearer kit individual brackets				
PBKITLBRKT	L bracket	150 x 150 x 26mm	304 stainless	each
PBKITRBRKT	R bracket	150 x 150 x 26mm	304 stainless	each
PBKITPLATE	nail on plate	190 x 100mm	304 stainless	each
UNAILS	U nail	105 x 40 x 5mm	304 stainless	each



retro pile bearer kit				
PBKITRETRO	for 4 piles	c/w 100 stainless teks	304 stainless	pack



retro pile bearer kit individual brackets				
PBB160S	L bracket	55 x 55 x 160mm	304 stainless	each
PBB120S	L bracket	100 x 100 x 120mm	304 stainless	each

Timber Connection Hardware



PK CODE	SIZE	FINISH	PACK QTY	UNIT
---------	------	--------	----------	------

framing bracket (joist hanger)

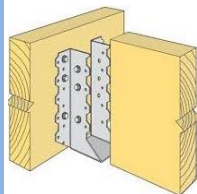

JH4690G	46 x 90mm	electro galv		1
JH46120G	46 x 120mm	electro galv		1
JH46180G	46 x 180mm	electro galv		1
JH95165G	95 x 165mm	electro galv		1
JH4690S	46 x 90mm	304 stainless		1
JH46120S	46 x 120mm	304 stainless		1
JH46180S	46 x 180mm	304 stainless		1

strap brace

SB30	25mm x 30m	0.8mm		zinc	pack
TEN4		Tensioners	4pack	zinc	pack
TEN5		Tensioners	5pack	zinc	pack



bracing anchor zinc

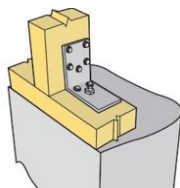

BPBA	89 x 50 x 5mm	c/w 12g x 35mm teks			1 pair
BPBAC	89 x 50 x 5mm	c/w 12g x 35mm teks	c/w 10mm x 140mm concrete bolts		1 pair

steel bracket



B50Z	42 x 62 x 50mm	2mm thick		zinc	pack
------	----------------	-----------	--	------	------

multigrip

MG114	35x35x114mm		galv	100	each
MGS114	35x35x114mm		stainless	100	each

sheet brace straps

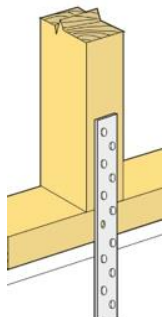

HGBS300	25mm x 300mm x 1mm		galv	100	each
HGBS400	25mm x 400mm x 1mm		galv	100	each
HGBS300S	25mm x 300mm x 1mm		304 Stainless	ETA September	100 each
HGBS400S	25mm x 400mm x 1mm		304 Stainless	ETA September	100 each

stren-joist stiffener

NPSJ	Single Joist		c/w screws		pack
NPSJD	Double Joist		c/w screws		pack



H Packers



PK CODE	GAUGE SIZE	COLOUR	BARCODE	JAR/PACK QTY
---------	---------------	--------	---------	-----------------

h packers

HP15YELLOW	1.5mm	yellow	9420080508080	100
HP2ORANGE	2.0mm	orange	9420080508097	100
HP3RED	3.0mm	red	9420080508103	100
HP4GREY	4.0mm	grey	9420080508110	100
HP5BLUE	5.0mm	blue	9420080508127	100
HP6BLACK	6.0mm	black	9420080508134	100
HP10GREEN	10.0mm	green	9420080508141	100



HPSP	1.5,2,3,4,5,6,10mm	yellow, orange, red, grey, blue, black, green	BARCODE 9420080508196	164
------	--------------------	---	-----------------------	-----

Assorted H Packer Starter Pack

164 PCS



48pcs
1.5mm

42pcs
2.0mm

28pcs
3.0mm

18pcs
5.0mm

16pcs
6.0mm

12pcs
10.0mm

SureFix - Wood Screws



PK CODE	GAUGE SIZE	LENGTH	DRIVER SIZE	DRIVE TYPE	HEAD TYPE	FINISH	JAR/PACK QTY	BULK QTY
---------	------------	--------	-------------	------------	-----------	--------	--------------	----------

square drive countersunk - yellow zinc

SFCS612	6g	12mm	No. 1	square	countersunk	yellow zinc	200	1000	20000
SFCS658	6g	16mm	No. 1	square	countersunk	yellow zinc	200	1000	18500
SFCS634	6g	20mm	No. 1	square	countersunk	yellow zinc	200	1000	17000
SFCS61	6g	25mm	No. 1	square	countersunk	yellow zinc	200	1000	15000
SFCS6114	6g	32mm	No. 1	square	countersunk	yellow zinc	200	1000	16000
SFCS6112	6g	38mm	No. 1	square	countersunk	yellow zinc	200	1000	10000

SFCS858	8g	16mm	No. 2	square	countersunk	yellow zinc	200	1600	20000
SFCS834	8g	20mm	No. 2	square	countersunk	yellow zinc	200	1500	18000
SFCS81	8g	25mm	No. 2	square	countersunk	yellow zinc	200	1000	13000
SFCS8118	8g	28mm	No. 2	square	countersunk	yellow zinc	200	1000	12500
SFCS835	8g	35mm	No. 2	square	countersunk	yellow zinc	200	700	9000
SFCS8114	8g	32mm	No. 2	square	countersunk	yellow zinc	200	800	12000
SFCS8112	8g	38mm	No. 2	square	countersunk	yellow zinc	200	600	7000
SFCS8134	8g	45mm	No. 2	square	countersunk	yellow zinc	150	500	5000
SFCS82	8g	50mm	No. 2	square	countersunk	yellow zinc	150	400	5000
SFCS8212	8g	63mm	No. 2	square	countersunk	yellow zinc	100	300	4000
SFCS83	8g	75mm	No. 2	square	countersunk	yellow zinc	80	250	4600

SFCS102	10g	50mm	No. 2	square	countersunk	yellow zinc	120	300	7000
SFCS10212	10g	63mm	No. 2	square	countersunk	yellow zinc	100	200	5200
SFCS103	10g	75mm	No. 2	square	countersunk	yellow zinc	80	180	3000
SFCS104	10g	100mm	No. 2	square	countersunk	yellow zinc	50	160	1350

square drive countersunk - stainless steel

SFSCS834	8g	20mm	No. 2	square	countersunk	304 stainless	100	500	1000
SFSCS81	8g	25mm	No. 2	square	countersunk	304 stainless	100	400	1000
SFSCS8114	8g	32mm	No. 2	square	countersunk	304 stainless	100	350	1000
SFSCS8112	8g	38mm	No. 2	square	countersunk	304 stainless	100	250	600
SFSCS8134	8g	45mm	No. 2	square	countersunk	304 stainless	50	175	1000
SFSCS82	8g	50mm	No. 2	square	countersunk	304 stainless	50	150	400
SFSCS8212	8g	63mm	No. 2	square	countersunk	304 stainless	50	125	250
SFSCS83	8g	75mm	No. 2	square	countersunk	304 stainless		250	1000
SFSCS890	8g	90mm	No. 2	square	countersunk	304 stainless		180	1000
SFSCS8100	8g	100mm	No. 2	square	countersunk	304 stainless		100	1000

SFSCS101	10g	25mm	No. 2	square	countersunk	304 stainless	50	250	750
SFSCS10112	10g	38mm	No. 2	square	countersunk	304 stainless	50	200	500

SFSCS102	10g	50mm	No. 2	square	countersunk	304 stainless	50	300	125
SFSCS10212	10g	63mm	No. 2	square	countersunk	304 stainless	40	100	250
SFSCS103	10g	75mm	No. 2	square	countersunk	304 stainless	200	500	1000
SFSCS10312	10g	88mm	No. 2	square	countersunk	304 stainless	30		1000

SFSCS122	12g	50mm	No. 2	square	countersunk	304 stainless	40	100	1000
SFSCS123	12g	75mm	No. 2	square	countersunk	304 stainless	30	70	1000
SFSCS124	12g	100mm	No. 2	square	countersunk	304 stainless			1000
SFSCS125	12g	125mm	No. 2	square	countersunk	304 stainless			1000

SFSCS834316	8g	20mm	No. 2	square	countersunk	316 stainless	100	500	1000
SFSCS81316	8g	25mm	No. 2	square	countersunk	316 stainless	100	400	1000
SFSCS8114316	8g	32mm	No. 2	square	countersunk	316 stainless	100	350	1000
SFSCS8112316	8g	38mm	No. 2	square	countersunk	316 stainless		250	600
SFSCS82316	8g	50mm	No. 2	square	countersunk	316 stainless	Sept	150	400

SFSCS10112316	10g	38mm	No. 2	square	countersunk	316 stainless	50	200	500
SFSCS102316	10g	50mm	No. 2	square	countersunk	316 stainless	125	300	500
SFSCS103316	10g	75mm	No. 2	square	countersunk	316 stainless	Sept	500	1000

SureFix, HingeFix & Euro Wood Screws



PK CODE	GAUGE SIZE	LENGTH	DRIVER SIZE	DRIVE TYPE	HEAD TYPE	FINISH	JAR/PACK QTY	BULK QTY
---------	------------	--------	-------------	------------	-----------	--------	--------------	----------

square drive countersunk - galv

SFGCS834	8g	20mm	No. 2	square	countersunk	galvanized	200	1500	18000
SFGCS81	8g	25mm	No. 2	square	countersunk	galvanized	200	1000	14000
SFGCS8118	8g	28mm	No. 2	square	countersunk	galvanized	200	1000	13000
SFGCS8114	8g	32mm	No. 2	square	countersunk	galvanized	200	800	12000
SFGCS8112	8g	38mm	No. 2	square	countersunk	galvanized	200	600	8000
SFGCS8134	8g	45mm	No. 2	square	countersunk	galvanized	150	500	6000
SFGCS82	8g	50mm	No. 2	square	countersunk	galvanized	150	350	5000
SFGCS8212	8g	63mm	No. 2	square	countersunk	galvanized	100	250	6600
SFGCS83	8g	75mm	No. 2	square	countersunk	galvanized	80	200	4600



SFGCS101	10g	25mm	No. 2	square	countersunk	galvanized	100	900	9500
SFGCS10112	10g	38mm	No. 2	square	countersunk	galvanized	90	500	6300
SFGCS102	10g	50mm	No. 2	square	countersunk	galvanized	80	300	6600
SFGCS10212	10g	63mm	No. 2	square	countersunk	galvanized	70	200	5200
SFGCS103	10g	75mm	No. 2	square	countersunk	galvanized	60	180	3600
SFGCS104	10g	100mm	No. 2	square	countersunk	galvanized	50	160	1350
SFGCS105	10g	125mm	No. 2	square	countersunk	galvanized	40	120	900

multi drive countersunk - zinc chromate

SFMD634	6g	20mm	No. 1		countersunk	zinc chromate	200		1000
SFMD61	6g	25mm	No. 1		countersunk	zinc chromate	200		1000
SFMD6114	6g	32mm	No. 1		countersunk	zinc chromate	200		1000
SFMD6112	6g	38mm	No. 1		countersunk	zinc chromate	150		1000



SFMD834	8g	20mm	No. 2		countersunk	zinc chromate	100		1000
SFMD81	8g	25mm	No. 2		countersunk	zinc chromate	100		1000
SFMD8114	8g	32mm	No. 2		countersunk	zinc chromate	100		1000
SFMD8112	8g	38mm	No. 2		countersunk	zinc chromate	100		1000
SFMD8134	8g	45mm	No. 2		countersunk	zinc chromate	100		1000
SFMD82	8g	50mm	No. 2		countersunk	zinc chromate	100		1000
SFMD8212	8g	63mm	No. 2		countersunk	zinc chromate	100		1000
SFMD103	10g	75mm	No. 2		countersunk	zinc chromate	80		1000

BITMF502		50mm	No. 2	multidrive bit					Each
----------	--	------	-------	----------------	--	--	--	--	------

hingeFix countersunk - zinc non ribbed bright zinc

HFCS612	6g	12mm	No. 1	square	countersunk	bright zinc	200		1000
HFCS658	6g	16mm	No. 1	square	countersunk	bright zinc	200		1000
HFCS634	6g	20mm	No. 1	square	countersunk	bright zinc	200		1000



HFCS658N2	6g	16mm	No. 2	square	countersunk	ETA Sept	200		1000
HFCS634N2	6g	20mm	No. 2	square	countersunk	ETA Sept	200		1000
HFCS61N2	6g	25mm	No. 2	square	countersunk	ETA Sept	200		1000

HFCS858	8g	16mm	No. 2	square	countersunk	bright zinc	200		1000
HFCS834	8g	20mm	No. 2	square	countersunk	bright zinc	200		1000
HFCS81	8g	25mm	No. 2	square	countersunk	bright zinc	200		1000
HFCS8114	8g	32mm	No. 2	square	countersunk	bright zinc	200		1000

pan pozi surefix

SFPP834	8g	20mm	No. 2	pozi	pan	zinc chromate	150		1000
SFPP81	8g	25mm	No. 2	pozi	pan	zinc chromate	150		1000

euro screw

EURO611	6.3mm	11mm	No. 2	square	countersunk	nickle plate	Sept		1000
---------	-------	------	-------	--------	-------------	--------------	------	--	------



Tek Screws



PK CODE	GAUGE SIZE	LENGTH	HEAD TYPE	FINISH	DRILLING POINT	DRIVE TYPE	PACK QTY	BOX QTY	BULK QTY
---------	------------	--------	-----------	--------	----------------	------------	----------	---------	----------

12g hex wood with neo galv

WTKHW1211254N	12g	25mm	hex	class 4 galv	type 17	with neo	100	250	1000
WTKHW1211354N	12g	35mm	hex	class 4 galv	type 17	with neo	70	250	1000
WTKHW1211404N	12g	40mm	hex	class 4 galv	type 17	with neo	70	200	1000
WTKHW1211504N	12g	50mm	hex	class 4 galv	type 17	with neo	50	160	1000
WTKHW1211654N	12g	65mm	hex	class 4 galv	type 17	with neo	40	120	1000
WTKHW1211754N	12g	75mm	hex	class 4 galv	type 17	with neo	30	100	1000

12g hex wood no neo galv

WTKHW1211254	12g	25mm	hex	class 4 galv	type 17	no neo	100	250	1000
WTKHW1211354	12g	35mm	hex	class 4 galv	type 17	no neo	70	250	1000
WTKHW1211454	12g	45mm	hex	class 4 galv	type 17	no neo	60	200	1000
WTKHW1211504	12g	50mm	hex	class 4 galv	type 17	no neo		160	1000
WTKHW1211654	12g	65mm	hex	class 4 galv	type 17	no neo		100	1000

14g hex wood with neo galv

WTKHW1410504N	14g	50mm	hex	class 4 galv	type 17	with neo	40	150	1000
WTKHW1410504NB	14g	50mm	hex	class 4 galv	type 17	with neo	Black 40		1000
WTKHW1410554N	14g	55mm	hex	class 4 galv	type 17	with neo			1000
WTKHW1410654N	14g	65mm	hex	class 4 galv	type 17	with neo		100	1000
WTKHW1410754N	14g	75mm	hex	class 4 galv	type 17	with neo	30	100	1000
WTKHW1410904N	14g	90mm	hex	class 4 galv	type 17	with neo	20	90	1000
WTKHW14101004N	14g	100mm	hex	class 4 galv	type 17	with neo	10	70	1000
WTKHW14101154N	14g	115mm	hex	class 4 galv	type 17	with neo	10		1000

14g hex wood no neo galv

WTKHW1410354	14g	35mm	hex	class 4 galv	type 17	no neo	50	200	1000
WTKHW1410504	14g	50mm	hex	class 4 galv	type 17	no neo		100	1000
WTKHW1410654	14g	65mm	hex	class 4 galv	type 17	no neo	35	100	1000
WTKHW1410754	14g	75mm	hex	class 4 galv	type 17	no neo	30	100	1000
WTKHW1410904	14g	90mm	hex	class 4 galv	type 17	no neo	20	100	1000
WTKHW14101004	14g	100mm	hex	class 4 galv	type 17	no neo		70	1000
WTKHW14101154	14g	115mm	hex	class 4 galv	type 17	no neo			1000
WTKHW14101254	14g	125mm	hex	class 4 galv	type 17	no neo			1000
WTKHW14101504	14g	150mm	hex	class 4 galv	type 17	no neo			1000

hex wood no neo 304 stainless

WTKHW1235S500	12g	35mm	hex	304 stainless	type 17	no neo	250	500	
WTKHW1435S500	14g	35mm	hex	304 stainless	type 17	no neo		200	500
WTKHW1450S500	14g	50mm	hex	304 stainless	type 17	no neo		150	500
WTKHW1475S250	14g	75mm	hex	304 stainless	type 17	no neo		100	250

hex wood no neo 316 stainless

WTKHW1235S5003	12g	35mm	hex	316 stainless	type 17	no neo		200	500
WTKHW1250S5003	12g	50mm	hex	316 stainless	type 17	no neo		150	500
WTKHW1265S4003	12g	65mm	hex	316 stainless	type 17	no neo		150	400
WTKHW1435S5003	14g	35mm	hex	316 stainless	type 17	no neo		200	500

hex wood no neo yellow zinc

WTKHW121135ZC	12g	35mm	hex	yellow zinc	type 17	no neo	70	250	1000
WTKHW141035ZC	14g	35mm	hex	yellow zinc	type 17	no neo	50	200	1000

blue concrete screws

						drill size	
FAST6545CS	6.5mm	45mm	countersunk	torx	ruspert	5mm	100
FAST6558CS	6.5mm	58mm	countersunk	torx	ruspert	5mm	100
FAST6570CS	6.5mm	70mm	countersunk	torx	ruspert	5mm	100
FAST6583CS	6.5mm	83mm	countersunk	torx	ruspert	5mm	100
FAST65100CS	6.5mm	100mm	countersunk	torx	ruspert	5mm	100
FAST6532H	6.5mm	32mm	hex	philips	ruspert	5mm	100
FAST6558H	6.5mm	58mm	hex	philips	ruspert	5mm	100
FAST6583H	6.5mm	83mm	hex	philips	ruspert	5mm	100



Metal & Wing Tek



hex metal

MTKHW1016163N	10g	16mm	hex	class 4 galv	neo	self drilling	50	650	1000
MTKHW1016163NB	10g	16mm	hex	class 4 galv	neo	self drilling Blk	50		1000
MTKHW1016253N	10g	25mm	hex	class 4 galv	neo	self drilling	45	500	1000
MTKHW1214204N	12g	20mm	hex	class 4 galv	neo	self drilling	40	350	1000
MTKHW1214254N	12g	25mm	hex	class 4 galv	neo	self drilling	38	300	1000
MTKHW1214254	12g	25mm	hex	class 4 galv	no neo	self drilling	38	300	1000
MTKHW1214304	12g	30mm	hex	class 4 galv	no neo	self drilling			1000
MTKHW1214354N	12g	35mm	hex	class 4 galv	neo	self drilling	34	250	1000
MTKHW1214454N	12g	45mm	hex	class 4 galv	neo	self drilling	30	200	1000
MTKHW1214554N	12g	55mm	hex	class 4 galv	neo	self drilling	24	150	1000
MTKHW1214654N	12g	65mm	hex	class 4 galv	neo	self drilling	22	100	1000
MTKHW1214754N	12g	75mm	hex	class 4 galv	neo	self drilling	18	100	1000
MTKHW121414654N	12 14g	65mm	hex	class 4 galv	roofing twin	self drilling	50	100	1000



MTKHW1410654N	14g	65mm	hex	class 4 galv		self drilling	35	100	1000
MTKHW1410754N	14g	75mm	hex	class 4 galv		self drilling	30	100	1000
MTKHW1410904N	14g	90mm	hex	class 4 galv		self drilling	15	75	1000



wafer/button metal

MTKB81812ZC	8g	12mm	wafer	yellow zinc	self drilling	No2 phillips	70	700	1000
MTKB81825ZC	8g	25mm	wafer	yellow zinc	self drilling	No2 phillips	60	600	1000
MTKB81830ZC	8g	30mm	wafer	yellow zinc	self drilling	No2 phillips	50	500	1000
MTKB81830G	8g	30mm	wafer	class 4 galv	self drilling	No2 phillips		500	1000
MTKB818504	8g	50mm	wafer	class 4 galv	self drilling	No2 phillips	18	300	1000



MTKW1016GB	10g	16mm	button	class 4 galv	self drilling	torx			100
MTKW1020GB	10g	20mm	button	class 4 galv	self drilling	torx			100
MTKW1030GB	10g	30mm	button	class 4 galv	self drilling	torx			100



pan metal 410 stainless

MTKSPS101612	10g	12mm	pan	410 stainless	self drilling	square	30	300	1000
MTKSPS101616	10g	16mm	pan	410 stainless	self drilling	square	25	250	1000
MTKSPS101620	10g	20mm	pan	410 stainless	self drilling	square	20	200	1000
MTKSPS101625	10g	25mm	pan	410 stainless	self drilling	square	18	180	1000



MTKSCS1025	10g	25mm	countersunk	410 stainless	self drilling	square	18	180	1000
MTKSCS414B	M4	14mm	countersunk	410 stainless	self drilling	black	Sept		1000
MTKSCS420B	M4	20mm	countersunk	410 stainless	self drilling	black	Sept		1000
MTKSCS515	M5	15mm	countersunk	410 stainless	self drilling		Sept		1000
MTKSCS517	M5	17mm	countersunk	410 stainless	self drilling		Sept		1000



purlin eye screw

PS6522ZC	6.5mm	22mm	eye	self drilling	yellow zinc				100
----------	-------	------	-----	---------------	-------------	--	--	--	-----



wing tek for 12mm steel large washer head

WINGTEK1465LH	14g	65mm	countersunk	torx	class 4 galv	large head			100
WINGTEK1480LH	14g	80mm	countersunk	torx	class 4 galv	large head			100
WINGTEK14110LH	14g	110mm	countersunk	torx	class 4 galv	large head			100



wing tek small head

WINGTEK1025B	10g	25mm	countersunk	torx	class 4 galv	small head			100
WINGTEK1035B	10g	35mm	countersunk	torx	class 4 galv	small head			100
WINGTEK1045B	10g	45mm	countersunk	torx	class 4 galv	small head			100
WINGTEK1055B	10g	55mm	countersunk	torx	class 4 galv	small head			100
WINGTEK1065B	10g	65mm	countersunk	torx	class 4 galv	small head			100
WINGTEK1075B	10g	75mm	countersunk	torx	class 4 galv	small head			100



Bugle Batten Screws

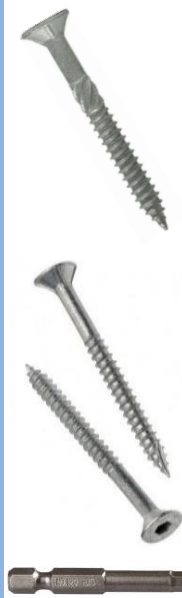

C4 galvanised

BBG1450T	14g	50mm	bugle	hex	class 4 galv	type 17	100	500
BBG1465T	14g	65mm	bugle	hex	class 4 galv	type 17		300
BBG1475T	14g	75mm	bugle	hex	class 4 galv	type 17	100	250
BBG1490T	14g	90mm	bugle	hex	class 4 galv	type 17		100
BBG14100T	14g	100mm	bugle	hex	class 4 galv	type 17		100
BBG14100T850	14g	100mm	bugle	hex	class 4 galv	type 17		850
BBG14125T	14g	125mm	bugle	hex	class 4 galv	type 17	100	200
BBG14150T	14g	150mm	bugle	hex	class 4 galv	type 17		100
BBG14175	14g	175mm	bugle	hex	class 4 galv	type 17		each
BBG14200B	14g	200mm	bugle	hex	class 4 galv	type 17		each

304 stainless

BBS1250T	12g	50mm	bugle	hex	304 stainless	type 17	100	500
BBS1265T	12g	65mm	bugle	hex	304 stainless	type 17	100	500
BBS1475T	14g	75mm	bugle	hex	304 stainless	type 17	100	250
BBS14100T	14g	100mm	bugle	hex	304 stainless	type 17	100	250
BBS14125T	14g	125mm	bugle	hex	304 stainless	type 17	100	200
BBS14150T	14g	150mm	bugle	hex	304 stainless	type 17	100	200

BITHEX550	H5	50mm		hex bit				each
-----------	----	------	--	---------	--	--	--	------

Decking/Gib/FastRight Screws

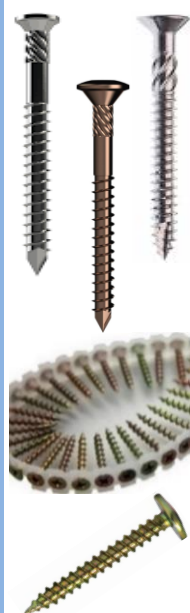

FastRight stainless

FDSS845	8g	45mm	countersunk	torx	304 stainless	type 17		500
FDSS1065SH	10g	65mm	countersunk	torx	304 stainless	small head		500
FDSS1065	10g	65mm	countersunk	torx	304 stainless	type 17		500
DSS1065	10g	65mm	countersunk	torx	304 stainless	diamond point		500
DSS1065B	10g	65mm	bronze	torx	304 stainless	diamond point		500
FDSS1075	10g	75mm	countersunk	torx	304 stainless	type 17		500
FDSS1265	12g	65mm	countersunk	hex socket	304 stainless	type 17		each
FDSS1280	12g	80mm	countersunk	hex socket	304 stainless	type 17		each

gib collated phillips drive countersunk (gib grabber)

PBS625HT	6g	25mm	high thread	phillips	countersunk	zinc chromate		1000
PBS632HT	6g	32mm	high thread	phillips	countersunk	zinc chromate		1000
PBS641HT	6g	41mm	high thread	phillips	countersunk	zinc chromate		1000
PBS632FT	6g	32mm	fine thread	phillips	countersunk	zinc chromate		1000

button head gib screws

PBSB812	8g	12mm		phillips	button	zinc chromate		1000
PBSB825	8g	25mm		phillips	button	zinc chromate		1000

FastRight quick screws

QDZC1050	10g	50mm	collated	square drive	zinc-chromate	No 3		1000
QDS1050	10g	50mm	collated	square drive	304-stainless	No 3		1000

Threaded Rod

threaded rod

TRS121316	M12	1M			316 stainless			each
TRS161316	M16	1M			316 stainless			each
TRZ101	M10	1M			Zinc			each
TRZ102	M10	2M			Zinc			each
TRZ121	M12	1M			Zinc			each
TRZ161	M16	1M			Zinc			each
TRG121	M12	1M			Galv			each
TRG161	M16	1M			Galv			each
TRGHT121	M12	1M			Galv			each
TRGHT161	M16	1M			Galv			each



Hex Bolts Stainless



PK CODE	GAUGE SIZE	LENGTH	HEAD TYPE	FINISH	QTY
---------	------------	--------	-----------	--------	-----

hex bolts stainless with nuts

HBS1265	12mm	65mm	hex	316 stainless	each
HBS1275	12mm	75mm	hex	316 stainless	each
HBS1290	12mm	90mm	hex	316 stainless	each
HBS12100	12mm	100mm	hex	316 stainless	each
HBS12110	12mm	110mm	hex	316 stainless	each
HBS12120	12mm	120mm	hex	316 stainless	each
HBS12130	12mm	130mm	hex	316 stainless	each
HBS12140	12mm	140mm	hex	316 stainless	each
HBS12150	12mm	150mm	hex	316 stainless	each
HBS12160	12mm	160mm	hex	316 stainless	each
HBS12170	12mm	170mm	hex	316 stainless	each
HBS12180	12mm	180mm	hex	316 stainless	each
HBS12190	12mm	190mm	hex	316 stainless	each
HBS12200	12mm	200mm	hex	316 stainless	each
HBS12210	12mm	210mm	hex	316 stainless	each
HBS12220	12mm	220mm	hex	316 stainless	each
HBS12230	12mm	230mm	hex	316 stainless	each
HBS12240	12mm	240mm	hex	316 stainless	each
HBS12250	12mm	250mm	hex	316 stainless	each



HBS1690	16mm	90mm	hex	316 stainless	each
HBS16100	16mm	100mm	hex	316 stainless	each
HBS16120	16mm	120mm	hex	316 stainless	each
HBS16140	16mm	140mm	hex	316 stainless	each
HBS16160	16mm	160mm	hex	316 stainless	each
HBS16180	16mm	180mm	hex	316 stainless	each
HBS16200	16mm	200mm	hex	316 stainless	each
HBS16220	16mm	220mm	hex	316 stainless	each
HBS16240	16mm	240mm	hex	316 stainless	each
HBS16260	16mm	260mm	hex	316 stainless	each
HBS16280	16mm	280mm	hex	316 stainless	each
HBS16300	16mm	300mm	hex	316 stainless	each

Coach Screws

stainless

CSS12150	12	150mm	hex	316 stainless	each
CSS12200	12	200mm	hex	316 stainless	each



Purlin Blue Screws

purlin blue screw

PBS1080	10g	80mm	countersunk	square	ruspert	250
---------	-----	------	-------------	--------	---------	-----



Machine Screws



PK CODE	GAUGE SIZE	LENGTH	DRIVE TYPE	HEAD TYPE	FINISH	JAR/PACK QTY	BULK QTY
brass imperial/metric							
MTRSB53234	5/32"	3/4"	slot	round	brass	25	1000
MTRSB5321	5/32"	1"	slot	round	brass	25	1000
MTRSB31612	3/16"	1/2"	slot	round	brass	25	1000
MTRSB31634	3/16"	3/4"	slot	round	brass	25	1000
MTRSB3161	3/16"	1"	slot	round	brass	25	1000
MTRSB316112	3/16"	1-1/2"	slot	round	brass	20	1000
MTPSB625	6mm	25mm	slot	pan	brass	15	1000
zinc imperial							
MTRS53234	5/32"	3/4"	slot	round	zinc	50	1000
MTRS5321	5/32"	1"	slot	round	zinc	50	1000
MTRS532112	5/32"	1 1/2"	slot	round	zinc	50	1000
MTRS31612	3/16"	1/2"	slot	round	zinc	50	1000
MTRS31634	3/16"	3/4"	slot	round	zinc	50	1000
MTRS3161	3/16"	1"	slot	round	zinc	50	1000
MTRS316112	3/16"	1 1/2"	slot	round	zinc	35	1000
MTRS1434	1/4"	3/4"	slot	round	zinc	35	1000
MTRS141	1/4"	1"	slot	round	zinc	30	1000
zinc metric							
MTPP310	M3	10mm	pozi	pan	zinc	50	1000
MTPP312	M3	12mm	pozi	pan	zinc	50	1000
MTPP316	M3	16mm	pozi	pan	zinc	50	1000
MTPP320	M3	20mm	pozi	pan	zinc	50	1000
MTPP325	M3	25mm	pozi	pan	zinc	50	1000
MTPP330	M3	30mm	pozi	pan	zinc	50	1000
MTPP340	M3	40mm	pozi	pan	zinc	50	1000
MTPP350	M3	50mm	pozi	pan	zinc	40	1000
MTPP410	M4	10mm	pozi	pan	zinc	40	1000
MTPP412	M4	12mm	pozi	pan	zinc	40	1000
MTPP416	M4	16mm	pozi	pan	zinc	40	1000
MTPP420	M4	20mm	pozi	pan	zinc	40	1000
MTPP425	M4	25mm	pozi	pan	zinc	40	1000
MTPP430	M4	30mm	pozi	pan	zinc	40	1000
MTPP440	M4	40mm	pozi	pan	zinc	40	1000
MTPP450	M4	50mm	pozi	pan	zinc	30	1000
MTPP510	M5	10mm	pozi	pan	zinc	40	1000
MTPP512	M5	12mm	pozi	pan	zinc	40	1000
MTPP516	M5	16mm	pozi	pan	zinc	40	1000
MTPP520	M5	20mm	pozi	pan	zinc	40	1000
MTPP525	M5	25mm	pozi	pan	zinc	40	1000
MTPP530	M5	30mm	pozi	pan	zinc	35	1000
MTPP540	M5	40mm	pozi	pan	zinc	25	1000
MTPP550	M5	50mm	pozi	pan	zinc	15	1000
MTPP610	M6	10mm	pozi	pan	zinc	40	1000
MTPP612	M6	12mm	pozi	pan	zinc	40	1000
MTPP616	M6	16mm	pozi	pan	zinc	40	1000
MTPP620	M6	20mm	pozi	pan	zinc	40	1000
MTPP625	M6	25mm	pozi	pan	zinc	30	1000
MTPP630	M6	25mm	pozi	pan	zinc	25	1000
MTPP640	M6	30mm	pozi	pan	zinc	20	1000
MTPP650	M6	50mm	pozi	pan	zinc	10	1000

Machine Screws



PK CODE	GAUGE SIZE	LENGTH	DRIVE TYPE	HEAD TYPE	FINISH	JAR/PACK QTY	BULK QTY
stainless metric							
MTSPS412	M4	12mm	slot	pan	304 stainless	20	1000
MTSPS420	M4	20mm	slot	pan	304 stainless	20	1000
MTSPS425	M4	25mm	slot	pan	304 stainless	18	1000
MTSPS440	M4	40mm	slot	pan	304 stainless	18	1000
MTSPS450	M4	50mm	slot	pan	304 stainless	15	1000
MTSPS512	M5	12mm	slot	pan	304 stainless	20	1000
MTSPS520	M5	20mm	slot	pan	304 stainless	20	1000
MTSPS525	M5	25mm	slot	pan	304 stainless	10	1000
MTSPS540	M5	40mm	slot	pan	304 stainless	10	1000
MTSPS550	M5	50mm	slot	pan	304 stainless	8	1000
MTSPS612	M6	12mm	slot	pan	304 stainless	15	1000
MTSPS620	M6	20mm	slot	pan	304 stainless	15	1000
MTSPS625	M6	25mm	slot	pan	304 stainless	10	1000
MTSPS640	M6	30mm	slot	pan	304 stainless	8	1000
MTSPS650	M6	50mm	slot	pan	304 stainless	8	1000

Gutter Bolts



mushroom head zinc imperial							
GB031612	3/16"	1/2"	slot	mushroom	zinc	50	1000
GB031634	3/16"	3/4"	slot	mushroom	zinc	45	1000
GB03161	3/16"	1"	slot	mushroom	zinc	40	1000
GB01412	1/4"	1/2"	slot	mushroom	zinc	40	1000
GB01434	1/4"	3/4"	slot	mushroom	zinc	35	1000
GB0141	1/4"	1"	slot	mushroom	zinc	30	1000

Washers



PK CODE	SIZE	OD	THICKNESS	FINISH	JAR/PACK QTY	QTY
round zinc						
WZ619	6mm	19mm	1.6mm	zinc	25	1000
WZ817	8mm	17mm	1.6mm	zinc	25	1000
WZ820	8mm	20mm	1.6mm	zinc	25	1000
WZ1021	10mm	21mm	1.6mm	zinc	25	1000
WZ1224	12mm	24mm	2mm	zinc	20	1000
WZ1232	12mm	32mm	2mm	zinc	20	1000
WZ1634	16mm	34mm	2mm	zinc	20	1000
round galv						
WG619	6mm	19mm	1.6mm	galv	25	1000
WG820	8mm	20mm	2mm	galv	25	1000
WG1024	10mm	24mm	2mm	galv	25	1000
WG1228	12mm	28mm	2.5mm	galv	25	1000
WG1634	16mm	34mm	3mm	galv	20	1000
round stainless						
WS612	6mm	12mm	1.6mm	304 stainless	25	1000
WS817	8mm	17mm	2mm	304 stainless	25	1000
WS1021	10mm	21mm	2mm	304 stainless	25	1000
WS1224	12mm	24mm	2mm	304 stainless	25	1000
square galv						
WG840403	8mm	40x40mm		3mm galv	50	each
WG1040403	10mm	40x40mm		3mm galv	50	each
WG1240403	12mm	40x40mm		3mm galv	50	each
WG1050503	10mm	50x50mm		3mm galv	50	each
WG1250502	12mm	50x50mm		2mm galv	50	each
WG1250503	12mm	50x50mm		3mm galv	50	each
WG1650503	16mm	50x50mm		3mm galv	50	each
square stainless						
WS1250503	12mm	50x50mm		3mm 304 stainless	25	each
WS1250503316	12mm	50x50mm		3mm 316 stainless	25	each



Nuts



hex pressed nuts zinc metric



NPM3	3mm	hex	zinc	50	1000
NPM4	4mm	hex	zinc	50	1000
NPM5	5mm	hex	zinc	50	1000
NPM6	6mm	hex	zinc	50	1000

hex nuts brass imperial/metric



NPB532	5/32"	hex	brass	25	1000
NPB316	3/16"	hex	brass	25	1000
NPB14	1/4"	hex	brass	20	1000
NPB6	6mm	hex	brass	15	1000

hex full nuts stainless metric



NHSM4	4mm	hex	304 stainless		1000
NHSM5	5mm	hex	304 stainless		1000
NHSM6	6mm	hex	304 stainless		1000
NHSM8	8mm	hex	304 stainless	16	1000
NHSM12316	12mm	hex	316 stainless	100	1000
NHSM16316	16mm	hex	316 stainless	100	1000

pressed nuts zinc imperial



NP18	1/8"	hex	zinc	50	1000
NP532	5/32"	hex	zinc	50	1000
NP316	3/16"	hex	zinc	50	1000
NP14	1/4"	hex	zinc	50	1000
NPS316	3/16"	square	zinc	50	1000
NPS14	1/4"	square	zinc	50	1000

hex full nuts zinc metric class 8



NH4	4mm	hex	zinc		1000
NH5	5mm	hex	zinc		1000
NH6	6mm	hex	zinc		1000
NH8	8mm	hex	zinc		1000
NH10	10mm	hex	zinc		1000
NH12	12mm	hex	zinc		1000
NH14	14mm	hex	zinc		1000
NH16	16mm	hex	zinc		1000
NH20	20mm	hex	zinc		1000

Landscaping Screws



PK CODE	SIZE	LENGTH	DRIVE	HEAD	FINISH	JAR/PACK QTY	QTY
landscaping screws							
LS690	6mm	90mm	torx	wafer	galv	each	1
LS6120	6mm	120mm	torx	wafer	galv	each	1
LS6140	6mm	140mm	torx	wafer	galv	each	1
LS6160	6mm	160mm	torx	wafer	galv	ETA September	each 1
LS6180	6mm	180mm	torx	wafer	galv	ETA September	each 1
LS6200	6mm	200mm	torx	wafer	galv	ETA September	each 1
LS880	8mm	80mm	torx	wafer	galv	each	1
LS8100	8mm	100mm	torx	wafer	galv	each	1
LS8120	8mm	120mm	torx	wafer	galv	each	1
LS8150	8mm	150mm	torx	wafer	galv	ETA September	each 1
LS8160	8mm	160mm	torx	wafer	galv	each	1
LS8180	8mm	180mm	torx	wafer	galv	ETA September	each 1
LS8200	8mm	200mm	torx	wafer	galv	each	1
LS8225	8mm	225mm	torx	wafer	galv	each	1
LS8240	8mm	240mm	torx	wafer	galv	each	1
LS8275	8mm	275mm	torx	wafer	galv	each	1
LS8300	8mm	300mm	torx	wafer	galv	each	1
LS10125	10mm	125mm	torx	wafer	galv	each	1
LS10150	10mm	150mm	torx	wafer	galv	each	1
LS10180	10mm	180mm	torx	wafer	galv	each	1
LS10200	10mm	200mm	torx	wafer	galv	ETA September	each 1
LS10225	10mm	225mm	torx	wafer	galv	ETA September	each 1
LS10250	10mm	250mm	torx	wafer	galv	ETA September	each 1
LS6120S	6mm	120mm	torx	wafer	304 stainless	each	1
LS6140S	6mm	140mm	torx	wafer	304 stainless	each	1
LS6160S	6mm	140mm	torx	wafer	304 stainless	ETA September	each 1
LS6180S	6mm	180mm	torx	wafer	304 stainless	ETA September	each 1
LS6200S	6mm	200mm	torx	wafer	304 stainless	each	1
LS8125S	8mm	125mm	torx	wafer	304 stainless	each	1
LS8140S	8mm	140mm	torx	wafer	304 stainless	ETA September	each 1
LS8160S	8mm	160mm	torx	wafer	304 stainless	each	1
LS8200S	8mm	200mm	torx	wafer	304 stainless	each	1
LS8225S	8mm	225mm	torx	wafer	304 stainless	ETA September	each 1
LS8250S	8mm	250mm	torx	wafer	304 stainless	ETA September	each 1
LS8275S	8mm	275mm	torx	wafer	304 stainless	ETA September	each 1



Self Tappers



PK CODE	GAUGE SIZE	LENGTH SIZE	DRIVE	HEAD	FINISH	JAR/PACK QTY	QTY
---------	------------	-------------	-------	------	--------	--------------	-----

stainless self tappers

STSPS612	6	1/2"	square	pan	304 stainless	50	1000
STSPS634	6	3/4"	square	pan	304 stainless	50	1000
STSPS61	6	1"	square	pan	304 stainless	50	1000
STSPS812	8	1/2"	square	pan	304 stainless	50	1000
STSPS834	8	3/4"	square	pan	304 stainless	50	1000
STSPS81	8	1"	square	pan	304 stainless	40	1000
STSPS8114	8	1 1/4"	square	pan	304 stainless	40	1000
STSPS1012	10	1/2"	square	pan	304 stainless	30	1000

truncated countersunk stainless

STSCS810TRUN	8	10mm	square	countersunk	316 stainless	ETA September	200	1000
STSCS812TRUN	8	12mm	square	countersunk	316 stainless	ETA September	200	1000
STSCS820TRUN	8	20mm	square	countersunk	316 stainless	ETA September	200	1000
STSCS1020TRUN	10	20mm	square	countersunk	316 stainless	ETA September	200	1000
STSCS1050TRUN	10	50mm	square	countersunk	316 stainless	ETA September	200	1000
STSCS810RHTRUN	8	10mm	square	raised	316 stainless black	Sept	200	1000

pan pozi zinc

STPP412	4	1/2"	pozi	pan	zinc		100	1000
STPP638	6	3/8"	pozi	pan	zinc		100	1000
STPP612	6	1/2"	pozi	pan	zinc		90	1000
STPP658	6	5/8"	pozi	pan	zinc		90	1000
STPP634	6	3/4"	pozi	pan	zinc		85	1000
STPP61	6	1"	pozi	pan	zinc		80	1000
STPP838	8	3/8"	pozi	pan	zinc		90	1000
STPP812	8	1/2"	pozi	pan	zinc		85	1000
STPP858	8	5/8"	pozi	pan	zinc		80	1000
STPP834	8	3/4"	pozi	pan	zinc		75	1000
STPP81	8	1"	pozi	pan	zinc		70	1000
STPP8114	8	1 1/4"	pozi	pan	zinc		65	1000
STPP1012	10	1/2"	pozi	pan	zinc		80	1000
STPP1034	10	3/4"	pozi	pan	zinc		70	1000
STPP101	10	1"	pozi	pan	zinc		65	1000

tie wire screw

TIEWIRE	6mm	75mm	eye		bright zinc		100	1000
---------	-----	------	-----	--	-------------	--	-----	------



Concrete Bolts & Screws

RAWLPLUG®

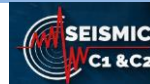

PK CODE	GAUGE SIZE	LENGTH		SEISMIC	BARCODE	ETA	QTY
---------	------------	--------	--	---------	---------	-----	-----

hex concrete bolts galv

HCBG650	6mm	50mm			9420080504419	ETA option 1	100
HCBG675	6mm	75mm			9420080504426	ETA option 1	100
HCBG6100	6mm	100mm			9420080506048	ETA option 1	100
HCBG860S	8mm	60mm		C1 & C2	9420080505096	ETA option 1	100
HCBG875S	8mm	75mm		C1 & C2	9420080505102	ETA option 1	100
HCBG8100S	8mm	100mm		C1 & C2	9420080505119	ETA option 1	100
HCBG8130S	8mm	130mm		C1 & C2	9420080505126	ETA option 1	50
HCBG8150S	8mm	150mm		C1 & C2	9420080505973	ETA option 1	25
HCBG1065	10mm	75mm			9420080506031	ETA option 1	50
HCBG1075S	10mm	75mm		C1 & C2	9420080505133	ETA option 1	50
HCBG10100S	10mm	100mm		C1 & C2	9420080505348	ETA option 1	50
HCBG10120S	10mm	120mm		C1 & C2	9420080505355	ETA option 1	25
HCBG10140S	10mm	140mm		C1 & C2	9420080505362	ETA option 1	25
ECB10140G	10mm	140mm	15kn		9420080502736	ETA option 1	25
ECB10140BG	10mm	140mm	15kn	blue head	9420080502743	ETA option 1	25
HCBG10160S	10mm	160mm		C1 & C2	9420080506024	ETA option 1	20
HCBG10180S	10mm	180mm		C1 & C2	9420080506208	ETA option 1	20
HCBG1275	12mm	75mm			9420080506000	ETA option 1	50
HCBG12100	12mm	100mm			9420080506017	ETA option 1	50
ECB12100G	12mm	100mm			9420080502750	ETA option 1	50
HCBG12150	12mm	150mm			9420080505089	ETA option 1	50
ECB12150G	12mm	150mm		C1 & C2	9420080506055	ETA option 1	50
SXTB12150G	12mm	150mm		C1 & C2	9420080504037	ETA option 1	25



countersunk concrete bolts galv

CSCBG650	6mm	50mm	torx 30	countersunk	9420080503894	ETA option 1	100
CSCBG675	6mm	75mm	torx 30	countersunk	9420080503900	ETA option 1	100
CSCBG6100	6mm	100mm	torx 30	countersunk	9420080503917	ETA option 1	100
CSCBG6120	6mm	120mm	torx 30	countersunk	9420080503924	ETA option 1	100
CSCBG860S	8mm	60mm	torx 45	countersunk	C1 & C2 9420080503931	ETA option 1	100
CSCBG875S	8mm	75mm	torx 45	countersunk	C1 & C2 9420080503948	ETA option 1	100
CSCBG8100S	8mm	100mm	torx 45	countersunk	C1 & C2 9420080503955	ETA option 1	100
CSCBG8130S	8mm	130mm	torx 45	countersunk	C1 & C2 9420080503962	ETA option 1	50
CSCBG8150S	8mm	150mm	torx 45	countersunk	C1 & C2 9420080503979	ETA option 1	50
CSCBG1075S	10mm	75mm	torx 50	countersunk	C1 & C2 9420080503986	ETA option 1	50
CSCBG10100S	10mm	100mm	torx 50	countersunk	C1 & C2 9420080503993	ETA option 1	50
CSCBG10120S	10mm	120mm	torx 50	countersunk	C1 & C2 9420080502545	ETA option 1	25
CSCBG10140S	10mm	140mm	torx 50	countersunk	C1 & C2 9420080502569	ETA option 1	25
CSCBG10160S	10mm	160mm	torx 50	countersunk	C1 & C2 9420080502576	ETA option 1	20



hex thru bolts galv

HTBG12100S	12mm	100mm	hex		C1 & C2 9420080504006	ETA option 1	50
HTBG12135S	12mm	135mm	hex		C1 & C2 9420080505409	ETA option 1	50
HTBG12150S	12mm	150mm	hex		C1 & C2 9420080505416	ETA option 1	50



hex thru bolts 316 stainless

HTBS12100S	12mm	100mm	hex		C1 & C2 9420080505423	ETA option 1	50
HTBS12125S	12mm	125mm	hex		C1 & C2 9420080505430	ETA option 1	50
HTBS12150S	12mm	150mm	hex		C1 & C2 9420080504044	ETA option 1	50
HTBS12180S	12mm	180mm	hex		C1 & C2 9420080504051	ETA option 1	50



nylon expansion plug & screw

NEP10100G	10mm	100mm	c/w screw	galv	9420080505447		50
NEP10120G	10mm	120mm	c/w screw	galv	9420080505454		50
NEP10140G	10mm	140mm	c/w screw	galv	9420080505461		50
NEP10100S	10mm	100mm	c/w screw	316 stainless	9420080504068		50
NEP10120S	10mm	120mm	c/w screw	316 stainless	9420080504075		50
NEP10140S	10mm	140mm	c/w screw	316 stainless	9420080504082		50



Light Duty Fixings



PK CODE	GAUGE SIZE	LENGTH	DRIVE TYPE	HEAD TYPE	MATERIAL	BARCODE	QTY
---------	------------	--------	------------	-----------	----------	---------	-----



plaster board screws

RDRA01	14mm	31mm			nylon	9420080506505	100
RDRA02	12mm	25mm			zp steel	9420080506512	100



spring toggles

RSPO03050	3mm	50mm	pozi/slot	pan	zp steel	9420080506529	100
RSPO05050	5mm	50mm	pozi/slot	pan	zp steel	9420080506598	100



hollow wall anchors

RSM04038	4mm	38mm	pozi/slot	mushroom	zp steel	9420080506192	100
RSM04059	4mm	49mm	pozi/slot	mushroom	zp steel	9420080506536	100
RSM06037	6mm	37mm	pozi/slot	mushroom	zp steel	9420080506543	100



hollow wall anchors

RSM04038D	4mm	38mm	pozi/slot	pan	zp steel	9420080506185	100
-----------	-----	------	-----------	-----	----------	---------------	-----



tappit nylon

RFXN05C025	5mm	25mm	pozi	cylinder	nylon	9420080506550	100
RFXN05C040	5mm	40mm	pozi	cylinder	nylon	9420080506567	100
RFXN06C035	6mm	35mm	pozi	cylinder	nylon	9420080506574	100
RFXN06C040	6mm	40mm	pozi	cylinder	nylon	9420080506581	100



wall plugs timber

WPT524T	5mm	24mm			timber	9420080506291	100
WPT628T	6mm	28mm			timber	9420080506307	100
WP730T	7mm	30mm			timber	9420080506314	100
WP832T	8mm	32mm			timber	9420080506321	100



wall plugs nylon

RFIXN05	5mm	25mm			nylon	9420080506260	100
RFIXN06	6mm	30mm			nylon	9420080506277	100
RFIXN08	8mm	40mm			nylon	9420080506284	100



metal pin anchor

RKMW06040	6mm	40mm		mushroom	zinc alloy	9420080506253	100
-----------	-----	------	--	----------	------------	---------------	-----



vertigo hangers concrete

RLX06X035I10ZP	6mm	35mm		10mm rod	zp steel	9420080506239	100
RLX06X055I10ZP	6mm	55mm		10mm rod	zp steel	9420080506246	100



drop in anchor

RDCL08	8mm	30mm			zp steel	9420080506215	100
RDCL10	10mm	40mm			zp steel	9420080506222	100



universal plugs nylon

RU1YEL96C	5mm	24mm		yellow	nylon	9420080506079	card 96
RU1RED48C	6mm	28mm		red	nylon	9420080506086	card 48
RU1BRN48C	7mm	30mm		brown	nylon	9420080506093	card 48
RU1BLU40C	8mm	32mm		blue	nylon	9420080506109	card 40
RU1GRY40C	10mm	36mm		grey	nylon	9420080506062	card 40





PK CODE	SIZE	TYPE	SEISMIC	MATERIAL	BARCODE	ETA	QTY
---------	------	------	---------	----------	---------	-----	-----

polyester resins

RKEMII300	300ml	styrene free	yes	polyester	9420080508158	yes	each
-----------	-------	--------------	-----	-----------	---------------	-----	------



hybrid resins

RKERII300	300ml	hybrid bonded anchor		hybrid	9420080508165	yes	each
-----------	-------	----------------------	--	--------	---------------	-----	------



epoxy resin

RKEXII385	385ml	pure epoxy res	yes		9420080508172	yes	each
RKEXII600	600ml	pure epoxy res	yes		9420080508189	yes	each



epoxy gun

RGUN600P		epoxy gun dual applicator		600ml	9420080508202		each
----------	--	---------------------------	--	-------	---------------	--	------



Premium epoxy gun

RGUNMULTI		epoxy gun dual applicator		385/600ml	9420080508219		each
-----------	--	---------------------------	--	-----------	---------------	--	------



epoxy gun

MN79013		caulking gun 230mm			9420080508226		each
---------	--	--------------------	--	--	---------------	--	------



Rivets



PK CODE	RIVET DIA mm	SHELL LENGTH	GRIP RANGE	INDUSTRY CODE	PIN FINISH	BODY FINISH	PACK/JAR QTY	BULK QTY
---------	--------------	--------------	------------	---------------	------------	-------------	--------------	----------

aluminium

R73AS42	3.2	7.0	1.6 - 3.2	73AS4-2	steel	aluminium	100	1000
R73AS43	3.2	8.6	3.2 - 4.8	73AS4-3	steel	aluminium	100	1000
R73AS44	3.2	10.2	4.8 - 6.4	73AS4-4	steel	aluminium	100	1000
R73AS45	3.2	11.7	6.4 - 7.9	73AS4-5	steel	aluminium	100	1000
R73AS46	3.2	13.3	7.9 - 9.5	73AS4-6	steel	aluminium	100	1000
R73AS48	3.2	16.5	9.5 - 12.7	73AS4-8	steel	aluminium	100	1000
R73AS410	3.2	19.7	12.7 - 15.9	73AS4-10	steel	aluminium	100	1000

R73AS52	4.0	7.6	1.6 - 3.2	73AS5-2	steel	aluminium	100	1000
R73AS53	4.0	9.2	3.2 - 4.8	73AS5-3	steel	aluminium	100	1000
R73AS54	4.0	10.8	4.8 - 6.4	73AS5-4	steel	aluminium	100	1000
R73AS55	4.0	12.3	6.4 - 7.9	73AS5-5	steel	aluminium	100	1000
R73AS56	4.0	13.8	7.9 - 9.5	73AS5-6	steel	aluminium	100	1000
R73AS58	4.0	17.1	9.5 - 12.7	73AS5-8	steel	aluminium	100	500
R73AS510	4.0	20.3	12.7 - 15.9	73AS5-10	steel	aluminium	100	500

aluminium

R73AS62	4.8	7.6	1.6 - 3.2	73AS6-2	steel	aluminium	100	500
R73AS63	4.8	9.8	3.2 - 4.8	73AS6-3	steel	aluminium	100	500
R73AS64	4.8	11.4	4.8 - 6.4	73AS6-4	steel	aluminium	100	500
R73AS65	4.8	13.0	6.4 - 7.9	73AS6-5	steel	aluminium	100	500
R73AS66	4.8	14.6	7.9 - 9.5	73AS6-6	steel	aluminium	90	500
R73AS68	4.8	17.8	9.5 - 12.7	73AS6-8	steel	aluminium	80	500
R73AS610	4.8	21.0	12.7 - 15.9	73AS6-10	steel	aluminium	50	500
R73AS612	4.8	24.1	15.9 - 19.0	73AS6-12	steel	aluminium	50	250
R73AS614	4.8	27.3	19.0 - 22.2	73AS6-14	steel	aluminium	50	250

large flange aluminium

R73ASL44	3.2	10.2	4.8 - 6.4	73ASL4-4	steel	aluminium	100	1000
R73ASL46	3.2	13.3	7.9 - 9.5	73ASL4-6	steel	aluminium	100	1000
R73ASL64	4.8	11.4	4.8 - 6.4	73ASL6-4	steel	aluminium	50	250
R73ASL65	4.8	13.0	6.4 - 7.9	73ASL6-5	steel	aluminium	50	250
R73ASL66	4.8	14.6	7.9 - 9.5	73ASL6-6	steel	aluminium	50	250
R73ASL68	4.8	17.8	9.5 - 12.7	73ASL6-8	steel	aluminium	40	250
R73ASL610	4.8	21.0	12.7 - 15.9	73ASL6-10	steel	aluminium	35	250
R73ASL612	4.8	24.1	15.9 - 19.0	73ASL6-12	steel	aluminium	30	250
R73ASL614	4.8	27.3	19.0 - 22.2	73ASL6-14	steel	aluminium	25	150
R73ASL616	4.8	30.5	22.2 - 25.4	73ASL6-16	steel	aluminium	25	200

monel

R73MS42	3.2	7.0	1.6 - 3.2	73MS4-2	steel	monel	100	1000
R73MS43	3.2	8.6	3.2 - 4.8	73MS4-3	steel	monel	100	1000
R73MS44	3.2	10.2	4.8 - 6.4	73MS4-4	steel	monel	100	1000
R73MS45	3.2	11.7	6.4 - 7.9	73MS4-5	steel	monel	100	1000
R73MS46	3.2	13.3	7.9 - 9.5	73MS4-6	steel	monel	100	1000
R73MS53	4.0	9.2	3.2 - 4.8	73MS5-3	steel	monel	100	1000
R73MS54	4.0	10.8	4.8 - 6.4	73MS5-4	steel	monel	100	1000

R73MS63	4.8	9.8	3.2 - 4.8	73MS6-3	steel	monel	100	500
R73MS64	4.8	11.4	4.8 - 6.4	73MS6-4	steel	monel	100	500
R73MS65	4.8	13.0	6.4 - 7.9	73MS6-5	steel	monel	100	500
R73MS66	4.8	14.6	7.9 - 9.5	73MS6-6	steel	monel	90	500

stainless steel

R73STST42	3.2	7.0	1.6 - 3.2	73STST4-2	s/steel	s/steel	100	1000
R73STST43	3.2	8.6	3.2 - 4.8	73STST4-3	s/steel	s/steel	100	1000
R73STST44	3.2	10.2	4.8 - 6.4	73STST4-4	s/steel	s/steel	100	1000
R73STST46	3.2	13.3	7.9 - 9.5	73STST4-5	s/steel	s/steel	100	1000

R73STST52	4.0	7.6	1.6 - 3.2	73STST5-2	s/steel	s/steel	100	1000
R73STST54	4.0	10.8	4.8 - 6.4	73STST5-4	s/steel	s/steel	100	1000

R73STST64	4.8	11.4	4.8 - 6.4	73STST6-4	s/steel	s/steel	50	500
R73STST66	4.8	14.6	7.9 - 9.5	73STST6-6	s/steel	s/steel	50	500

Rivets



PK CODE	RIVET DIA mm	SHELL LENGTH	GRIP RANGE	INDUSTRY CODE	PIN FINISH	BODY FINISH	PACK/JAR QTY	BULK QTY
steel								
R73SS42	3.2	7.0	1.6 - 3.2	73SS4-2	steel	steel	100	1000
R73SS43	3.2	8.6	3.2 - 4.8	73SS4-3	steel	steel	100	1000
R73SS44	3.2	10.2	4.8 - 6.4	73SS4-4	steel	steel	100	1000
R73SS46	3.2	13.3	7.9 - 9.5	73SS4-6	steel	steel	100	1000
R73SS54	4.0	10.8	4.8 - 6.4	73SS5-4	steel	steel	100	1000
R73SS64	4.8	11.4	4.8 - 6.4	73SS6-4	steel	steel	100	500
R73SS66	4.8	14.6	7.9 - 9.5	73SS6-6	steel	steel	90	500

Coloured Rivets

PK CODE	RIVET DIA mm	SHELL LENGTH	GRIP RANGE	INDUSTRY CODE	BODY COLOUR	BODY MATERIAL	PACK/JAR QTY	BULK QTY
coloured aluminium 4-2								
R73AS42EB	3.2	7.0	1.6 - 3.2	73AS4-2	ebony	aluminium	100	1000
R73AS42W	3.2	7.0	1.6 - 3.2	73AS4-2	white	aluminium	100	1000
coloured aluminium 4-3								
R73AS43EB	3.2	8.6	3.2 - 4.8	73AS4-3	ebony	aluminium	100	1000
R73AS43FP	3.2	8.6	3.2 - 4.8	73AS4-3	flax pod	aluminium	100	1000
R73AS43GF	3.2	8.6	3.2 - 4.8	73AS4-3	grey friars	aluminium	100	1000
R73AS43RMG	3.2	8.6	3.2 - 4.8	73AS4-3	river mist green	aluminium	100	1000
R73AS43SC	3.2	8.6	3.2 - 4.8	73AS4-3	smooth cream	aluminium	100	1000
R73AS43S	3.2	8.6	3.2 - 4.8	73AS4-3	scoria	aluminium	100	1000
R73AS43SG	3.2	8.6	3.2 - 4.8	73AS4-3	slate grey	aluminium	100	1000
R73AS43T	3.2	8.6	3.2 - 4.8	73AS4-3	titania	aluminium	100	1000
R73AS43DS	3.2	8.6	3.2 - 4.8	73AS4-3	desert sand	aluminium	100	1000
R73AS43IS	3.2	8.6	3.2 - 4.8	73AS4-3	iron sand	aluminium	100	1000
R73AS43PG	3.2	8.6	3.2 - 4.8	73AS4-3	permanent greer	aluminium	100	1000
R73AS43GG	3.2	8.6	3.2 - 4.8	73AS4-3	gull grey	aluminium	100	1000
R73AS43RG	3.2	8.6	3.2 - 4.8	73AS4-3	river gum	aluminium	100	1000
R73AS43K	3.2	8.6	3.2 - 4.8	73AS4-3	karaka	aluminium	100	1000
R73AS43W	3.2	8.6	3.2 - 4.8	73AS4-3	white	aluminium	100	1000
R73AS43WG	3.2	8.6	3.2 - 4.8	73AS4-3	windsor grey	aluminium	100	1000
coloured aluminium 4-4								
R73AS44EB	3.2	10.2	4.8 - 6.2	73AS4-4	ebony	aluminium	100	1000
R73AS44W	3.2	10.2	4.8 - 6.2	73AS4-4	white	aluminium	100	1000
coloured aluminium 4-6								
R73AS46EB	3.2	13.3	7.9 - 9.5	73AS4-6	ebony	aluminium	100	1000
R73AS46W	3.2	13.3	7.9 - 9.5	73AS4-6	white	aluminium	100	1000
coloured aluminium 5-2								
R73AS52EB	4.0	7.6	1.6 - 3.2	73AS5-2	ebony	aluminium	100	1000
R73AS52W	4.0	7.6	1.6 - 3.2	73AS5-2	white	aluminium	100	1000



Coloured Rivets

PK CODE	RIVET DIA mm	SHELL LENGTH	GRIP RANGE	INDUSTRY CODE	BODY COLOUR	BODY MATERIAL	PACK/JAR QTY	BULK QTY
coloured aluminium 5-3								
R73AS53EB	4.0	9.2	3.2 - 4.8	73AS5-3	ebony	aluminium	100	1000
R73AS53FP	4.0	9.2	3.2 - 4.8	73AS5-3	flax pod	aluminium	100	1000
R73AS53GF	4.0	9.2	3.2 - 4.8	73AS5-3	grey friars	aluminium	100	1000
R73AS53RMG	4.0	9.2	3.2 - 4.8	73AS5-3	river mist green	aluminium	100	1000
R73AS53SC	4.0	9.2	3.2 - 4.8	73AS5-3	smooth cream	aluminium	100	1000
R73AS53S	4.0	9.2	3.2 - 4.8	73AS5-3	scoria	aluminium	100	1000
R73AS53SG	4.0	9.2	3.2 - 4.8	73AS5-3	sandstone grey	aluminium	100	1000
R73AS53T	4.0	9.2	3.2 - 4.8	73AS5-3	titania	aluminium	100	1000
R73AS53DS	4.0	9.2	3.2 - 4.8	73AS5-3	desert sand	aluminium	100	1000
R73AS53IS	4.0	9.2	3.2 - 4.8	73AS5-3	iron sand	aluminium	100	1000
R73AS53PG	4.0	9.2	3.2 - 4.8	73AS5-3	permanent greer	aluminium	100	1000
R73AS53GG	4.0	9.2	3.2 - 4.8	73AS5-3	gull grey	aluminium	100	1000
R73AS53RG	4.0	9.2	3.2 - 4.8	73AS5-3	river gum	aluminium	100	1000
R73AS53K	4.0	9.2	3.2 - 4.8	73AS5-3	karaka	aluminium	100	1000
R73AS53W	4.0	9.2	3.2 - 4.8	73AS5-3	white	aluminium	100	1000
R73AS53WG	4.0	9.2	3.2 - 4.8	73AS5-3	windsor grey	aluminium	100	1000
R73AS53SLG	4.0	9.2	3.2 - 4.9	73AS5-3	slate grey	aluminium	100	1000



coloured aluminium 5-6								
R73AS56EB	4.0	13.8	7.9 - 9.5	73AS5-6	ebony	aluminium	100	1000
R73AS56W	4.0	13.8	7.9 - 9.5	73AS5-6	white	aluminium	100	1000

coloured aluminium 6-6								
R73AS66EB	4.8	14.6	7.9 - 9.5	73AS6-6	ebony	aluminium	100	1000
R73AS66IS	4.8	14.6	7.9 - 9.5	73AS6-6	iron sand	aluminium	100	1000
R73AS66T	4.8	14.6	7.9 - 9.6	73AS6-6	titania	aluminium	100	1000

Rivet Tools

PK CODE	TYPE	GRIP RANGE	GRIP RANGE STAINLESS	QTY
SRCS5P	air	3.2 - 4.8	3.2 - 4.00	1
SRCHR708	hand	3.2 - 4.8		1
SRCHR710	lazy tong	3.2 - 6.4		1
SRCHR730	lever long arm	3.2 - 6.4		1





11 Kent Street
Frankton
HAMILTON 3204

Warehouse

Isaac 07 390 1228
warehouse@pkfasteners.co.nz

Quotes

Russell: 0274 922 220
russell@pkfasteners.co.nz

Admin

Dianne: 0274 544 907
dianne@pkfasteners.co.nz

Sales

Steve: 0274 878 071
steve@pkfasteners.co.nz

Lance: 022 031 3429
lance @pkfasteners.co.nz

Proudly Supporting
Thames Coast Kiwi Care

